



From DomOS Extended here is DomOS Easy with the new PLUG & PLAY kits of home automation for a fast and low-cost installation.

You can supervise and manage the functions by Smartphone and Tablet with the Android and iOS App.





easy kit MINI



8 ON/OFF LIGHTS



4 ROLLING SHUTTERS/MOTORIZED BLINDS



2 TEMPERATURE ZONES DAY/NIGHT



2 ANTITHEFT ZONES



2 INTERNAL/EXTERNAL RINGTONES

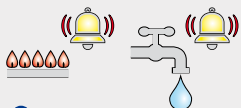

2 GAS/WATER ALARM

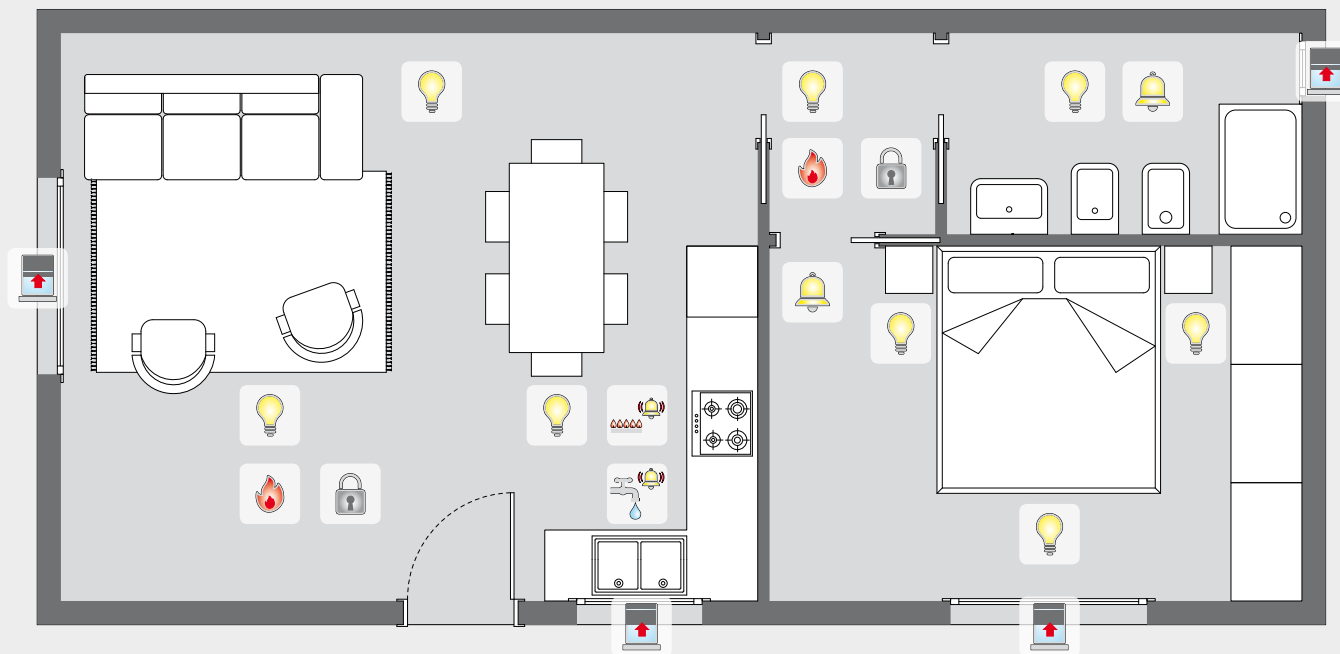

DomOS Easy kits of home automation, the PLUG & PLAY solution available to everyone.

The devices contained in the kits do not require any specific programming because they are already programmed in the factory. This allows you a fast and low-cost installation.



N°1 MODULE TKC23
electronic control unit with integrated graphic interface



N°1 MODULE UPS5
power supply with battery charger, output 24Vdc 5A



N°1 MODULE TKC35
4 passive temperature probes acquisition module



N°1 MODULE ASW1
switching power supply, output 24Vdc 1A



N°2 PROBES TKC33
passive temperature probe, range from -50 °C to +120 °C



N°3 MODULES TKC18
8 relays output module with NO contacts 230Vac 16A AC1



N°2 MODULES TKC26
active 16 inputs module to connect dry contacts

FEATURES EASY KIT MINI

- PLUG & PLAY installation (kit already programmed in factory)
- management of functions by Smartphone and Tablet with the Android and iOS App, and by PC
- management of functions by wall-mounted Touch Screen (optional)
- scenarios that can be set by the user
- custom graphics by VNC
- expandable kit with extra functions
- control panel (on demand)

APPLICATIONS

housing up to two rooms

Anything that is not explicitly mentioned must be considered excluded from this kit. DSSTech srl reserves the right to modify products details and features at any time. The products may therefore differ from those shown.



easy kit COMPACT



11 ON/OFF LIGHTS



4 DIMMABLE LIGHTS



6 ROLLING SHUTTERS/MOTORIZED BLINDS



4 TEMPERATURE ZONES DAY/NIGHT



4 ANTITHEFT ZONES



2 INTERNAL/EXTERNAL RINGTONES

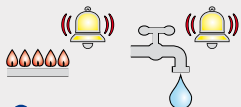

2 GAS/WATER ALARM

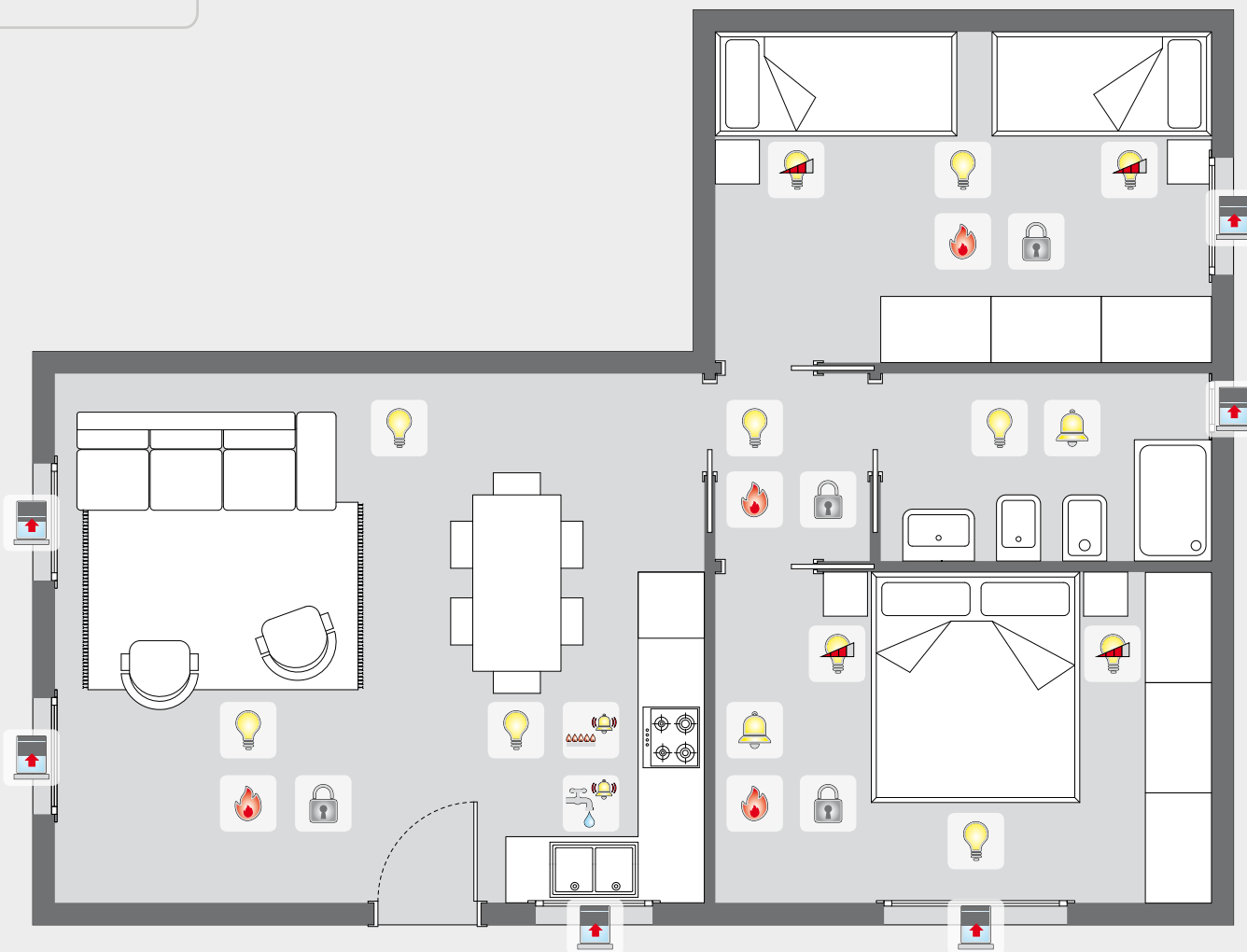

You can supervise and manage the functions by Smartphone, Tablet and PC (wall-mounted Touch Screen is optional).

Thanks to the Android and iOS App, an intuitive interface allows you to manage your home with full autonomy and safety, even remotely.



N°1 MODULE TKC23
electronic control unit with integrated graphic interface



N°1 MODULE TKC16
8 inputs active module with led indicators



N°1 MODULE TKC35
4 passive temperature probes acquisition module



N°1 MODULE TKC19
4 analogic outputs 0-10Vdc to control dimmer



N°4 PROBES TKC33
passive temperature probe, range from -50 °C to +120 °C



N°1 MODULE UPS5
power supply with battery charger, output 24Vdc 5A



N°4 MODULES TKC18
8 relays output module with NO contacts 230Vac 16A AC1



N°1 MODULE ASW1
switching power supply, output 24Vdc 1A



N°2 MODULES TKC26
active 16 inputs module to connect dry contacts

FEATURES EASY KIT COMPACT

- PLUG & PLAY installation (kit already programmed in factory)
- management of functions by Smartphone and Tablet with the Android and iOS App, and by PC
- management of functions by wall-mounted Touch Screen (optional)
- scenarios that can be set by the user
- custom graphics by VNC
- expandable kit with extra functions
- control panel (on demand)

APPLICATIONS

housing up to four rooms

Anything that is not explicitly mentioned must be considered excluded from this kit.
DSSTech srl reserves the right to modify products details and features at any time.
The products may therefore differ from those shown.



easy kit COMFORT



12 ON/OFF LIGHTS



4 DIMMABLE LIGHTS



8 ROLLING SHUTTERS/MOTORIZED BLINDS



7 TEMPERATURE ZONES DAY/NIGHT



7 ANTITHEFT ZONES



2 INTERNAL/EXTERNAL RINGTONES

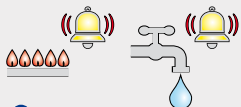

2 GAS/WATER ALARM

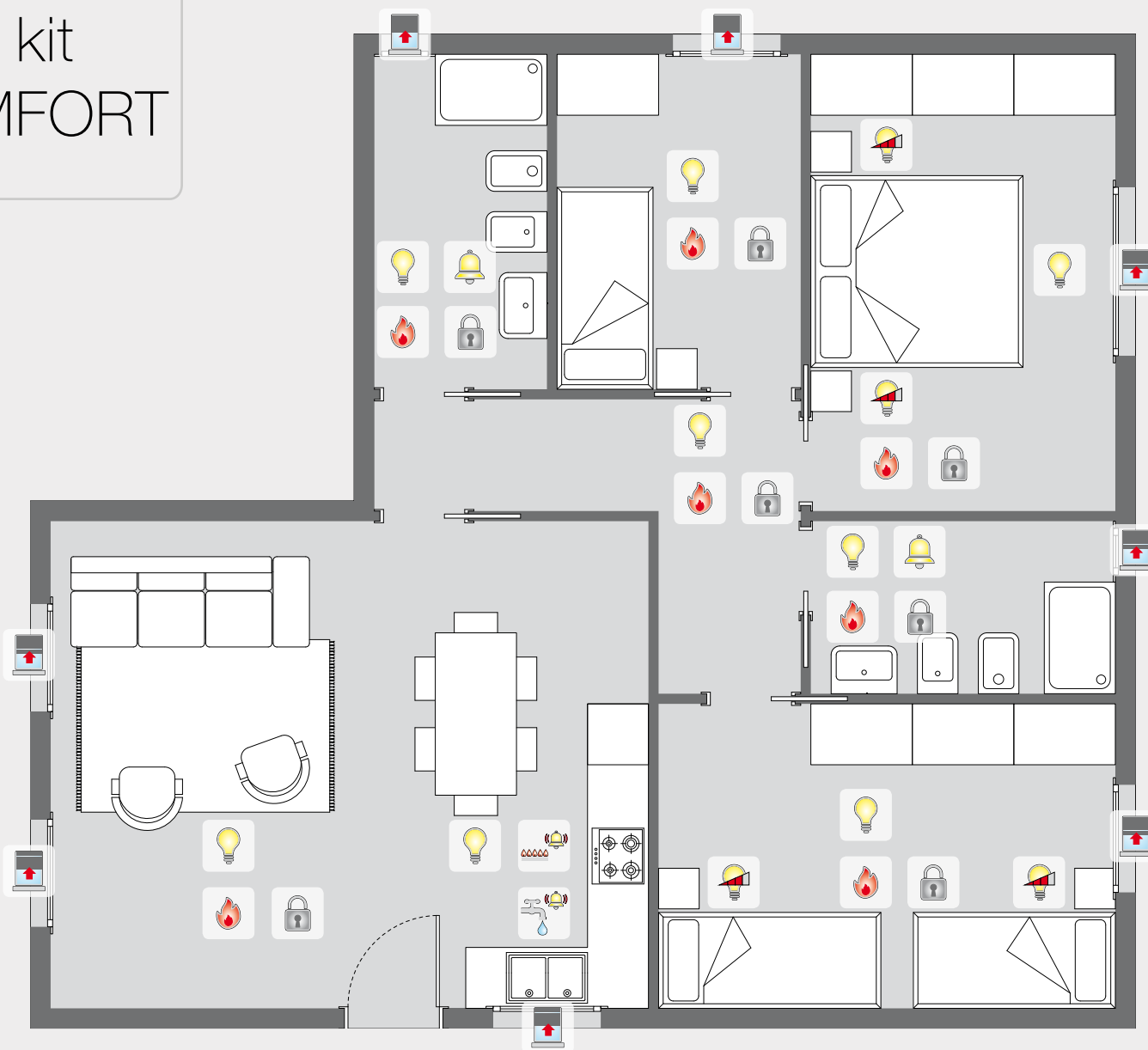

The Mini, Compact and Comfort Easy kits are part of DomOS, the expandable and modular home automation system that can grow as necessary.

Once you have installed Easy kit, you can expand the available features with new features according to your demands of personalization.



N°1 MODULE TKC23
electronic control unit with integrated graphic interface



N°1 MODULE TKC19
4 analogic outputs 0-10Vdc to control dimmer



N°1 MODULE TKC35
4 passive temperature probes acquisition module



N°1 MODULE UPS5
power supply with battery charger, output 24Vdc 5A



N°4 PROBES TKC33
passive temperature probe, range from -50 °C to +120 °C



N°1 MODULE ASW1
switching power supply, output 24Vdc 1A



N°4 MODULES TKC18
8 relays output module with NO contacts 230Vac 16A AC1



N°2 MODULES TKC26
active 16 inputs module to connect dry contacts

FEATURES EASY KIT COMFORT

- PLUG & PLAY installation (kit already programmed in factory)
- management of functions by Smartphone and Tablet with the Android and iOS App, and by PC
- management of functions by wall-mounted Touch Screen (optional)
- scenarios that can be set by the user
- custom graphics by VNC
- expandable kit with extra functions
- control panel (on demand)

APPLICATIONS

housing up to five rooms

Anything that is not explicitly mentioned must be considered excluded from this kit.
DSSTech srl reserves the right to modify products details and features at any time.
The products may therefore differ from those shown.

dom|OS
extended

dom|OS
easy

dom|OS
home

dom|OS
care

dom|OS
building



 via dell'Artigianato 3
36034 Malo (VI)

 +39 0445 637541

 info@dsstech.it

 www.dsstechautomation.com
www.rasotto.com